



SMC Series are subminiature precision connectors and are similar in size and construction to SMB, but with 10-32 threaded coupling. These are best suited for applications from DC - 4 GHz. The SMC connectors are made of Brass with Gold or Nickel plated. Standard configurations are shown on product pages, please contact factory for your custom designs.

## TECHNICAL SPECIFICATIONS

### Electrical

Impedance:	50 ohms
Freq Range:	DC - 4 GHz (usable 10 GHz)
Voltage Rating:	335 V Peak
Constant Resistance:	Center Contact: 6.0 Milli ohms Body: 1.0 Milli ohms Braid to Body: 1.0 Milli ohms
Insulation Resistance:	1,000 Meg ohms
RF Leakage:	-55 dB min @ 2-3 GHz



### Material/Finish

Body:	<i>(Standard)</i> Brass with Gold <i>(Option)</i> Brass with Nickel plated. To order Brass/Nickel, add "BN" as a prefix to the P/N.
Center Contact Male:	Extruded Brass, gold plated
Center Contact Female:	Beryllium Copper, gold plated
Dielectric:	PTFE Fluorocarbon per ASTM D-1457
Gasket:	Silicone Rubber ZZ-R-765
Crimp Ferrule:	Annealed Copper

### Mechanical

Mating:	50 ohm screw on coupling (SMC)
Mating:	50 ohm snap-on coupling (SMB)
Connector Durability:	500 cycles
Mating Torque:	Recommend 2 - 3 inch per pound.
Cable Affixment to center Contact:	Solder

**Note:** These characteristics are typical but may not apply to all connectors.



# SMC CONNECTORS



\*Add "BN" as a prefix to P/N to order Brass/Nickel.  
 \*Add "NC" as a prefix to P/N to order W/Out Captivation.

SMC

**(SMC Jack)**  
**2-Hole Flange Mount**  
**Solder Cup Contact**

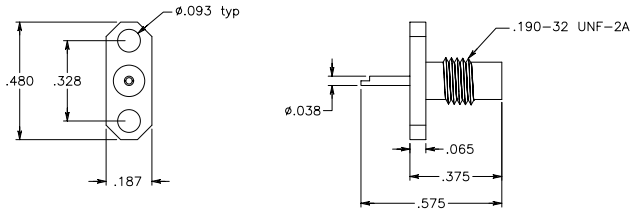

**PART #**  
 SMC 7000-1001

Captive Contact

**(SMC Jack)**  
**Right Angle**  
**Printed Circuit Mount**

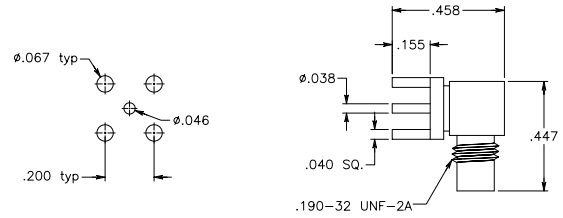

**PART #**  
 SMC 7000-1004

Captive Contact

**(SMC Jack)**  
**4-Hole Flange Mount**  
**Solder Cup Contact**

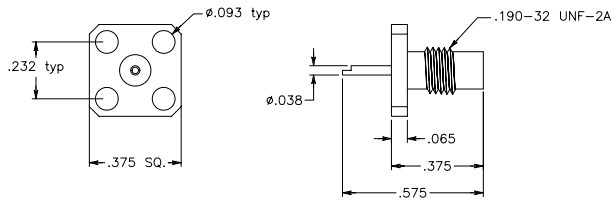

**PART #**  
 SMC 7000-1002

Captive Contact

**(SMC Jack)**  
**Printed Circuit Mount**

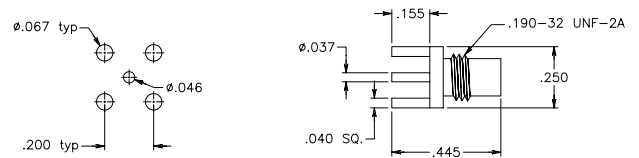

**PART #**  
 SMC 7000-1005

Captive Contact

**(SMC Jack)**  
**4-Hole Flange Mount**  
**Solder Cup Contact**

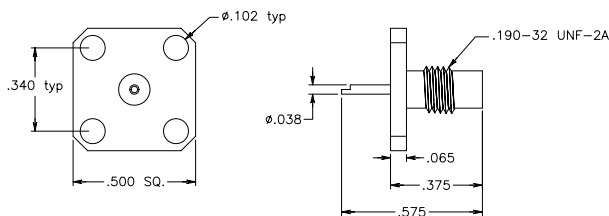

**PART #**  
 SMC 7000-1003

Captive Contact

**(SMC Plug)**  
**Bulk Head Receptacle**  
**Front Mount Solder Cup Terminal**

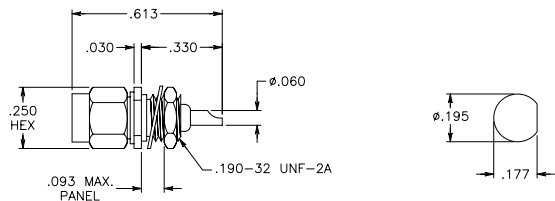

**PART #**  
 SMC 7000-1006

Captive Contact

# SMC CONNECTORS



\*Add "BN" as a prefix to P/N to order Brass/Nickel.  
 \*Add "NC" as a prefix to P/N to order W/Out Captivation.

**(SMC Jack)**  
 Front Angle Bulk Head Receptacle  
 Front Mount Solder Cup Terminal

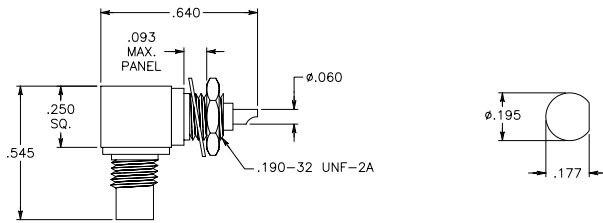

**PART #**  
 SMC 7000-1007

Captive Contact

**(SMC Jack)**  
 Bulk Head Crimp Attachment  
 For RG55, RG141, RG142, RG223 & RG400

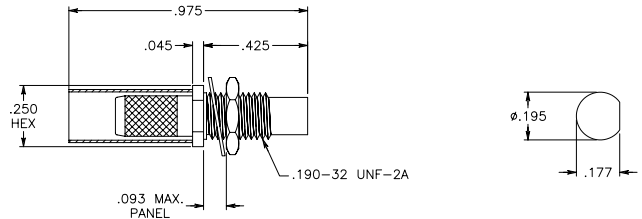

**PART #**  
 SMC 7000-1010

Captive Contact

**(SMC Jack)**  
 Bulk Head Receptacle  
 Front Mount Solder Cup Terminal

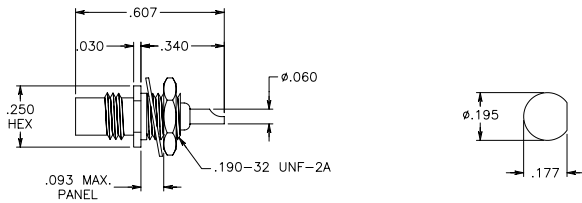

**PART #**  
 SMC 7000-1008

Captive Contact

**(SMC Jack)**  
 Crimp Attachment  
 For RG174, RG188 & RG316

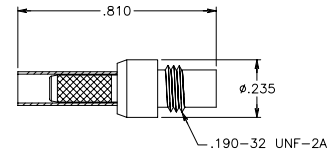

**PART #**  
 SMC 7000-1011

Captive Contact

**(SMC Jack)**  
 Bulk Head Receptacle  
 Rear Mount Solder Cup Terminal

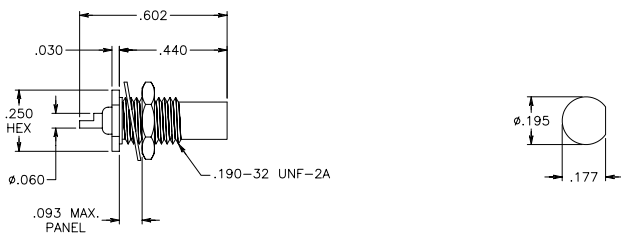

**PART #**  
 SMC 7000-1009

Captive Contact

**(SMC Plug)**  
 Right Angle Crimp Attachment  
 For RG178 & RG196

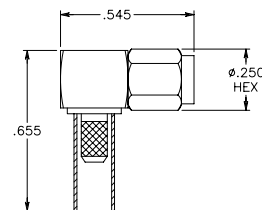

**PART #**  
 SMC 7000-1012

Captive Contact